

## OPENING HOURS

The Library is open from 9.00 am to 7.00 pm during Term time and  
9.00 am to 5.00 pm outside of Term.  
Full details can be found on the Centre website [www.oxcis.ac.uk/library](http://www.oxcis.ac.uk/library)

## HOW TO FIND US:

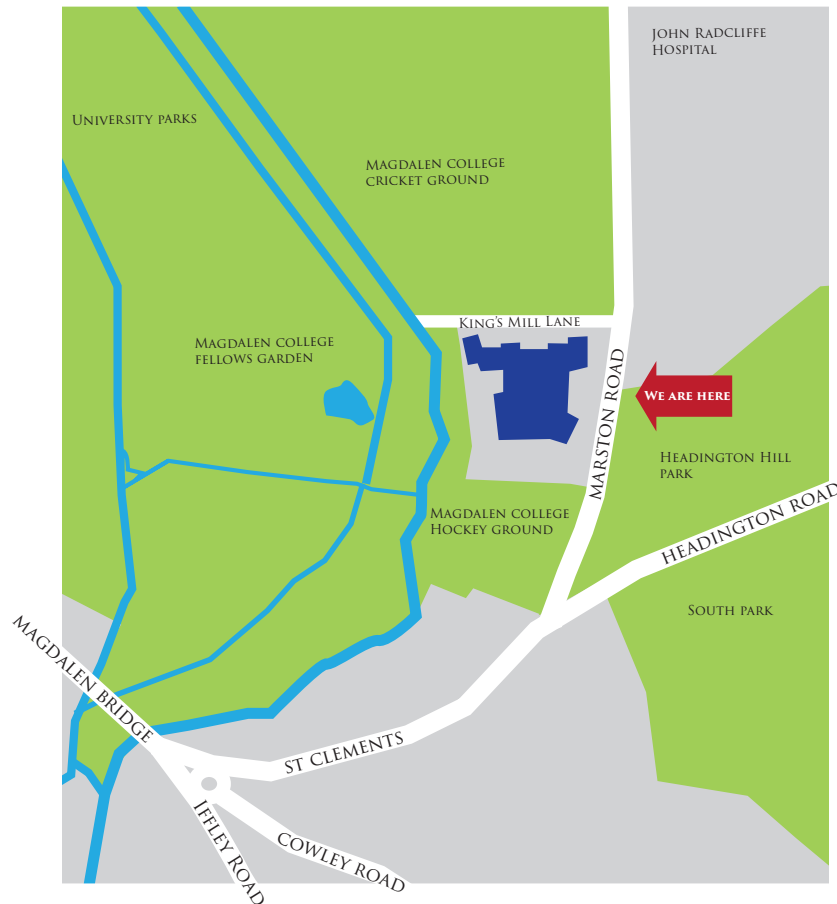

Bus: X3,13, X13 from the city centre to the second bus stop on Marston Road.

Bicycle racks are available within the perimeter of the building.

OXFORD CENTRE FOR ISLAMIC STUDIES  
MARSTON ROAD, OXFORD OX3 0EE, UK  
Telephone: +44 (0) 1865 618550  
Email: [library@oxcis.ac.uk](mailto:library@oxcis.ac.uk) [www.oxcis.ac.uk](http://www.oxcis.ac.uk)

Oxford Centre for Islamic Studies  
*Incorporated by Royal Charter*

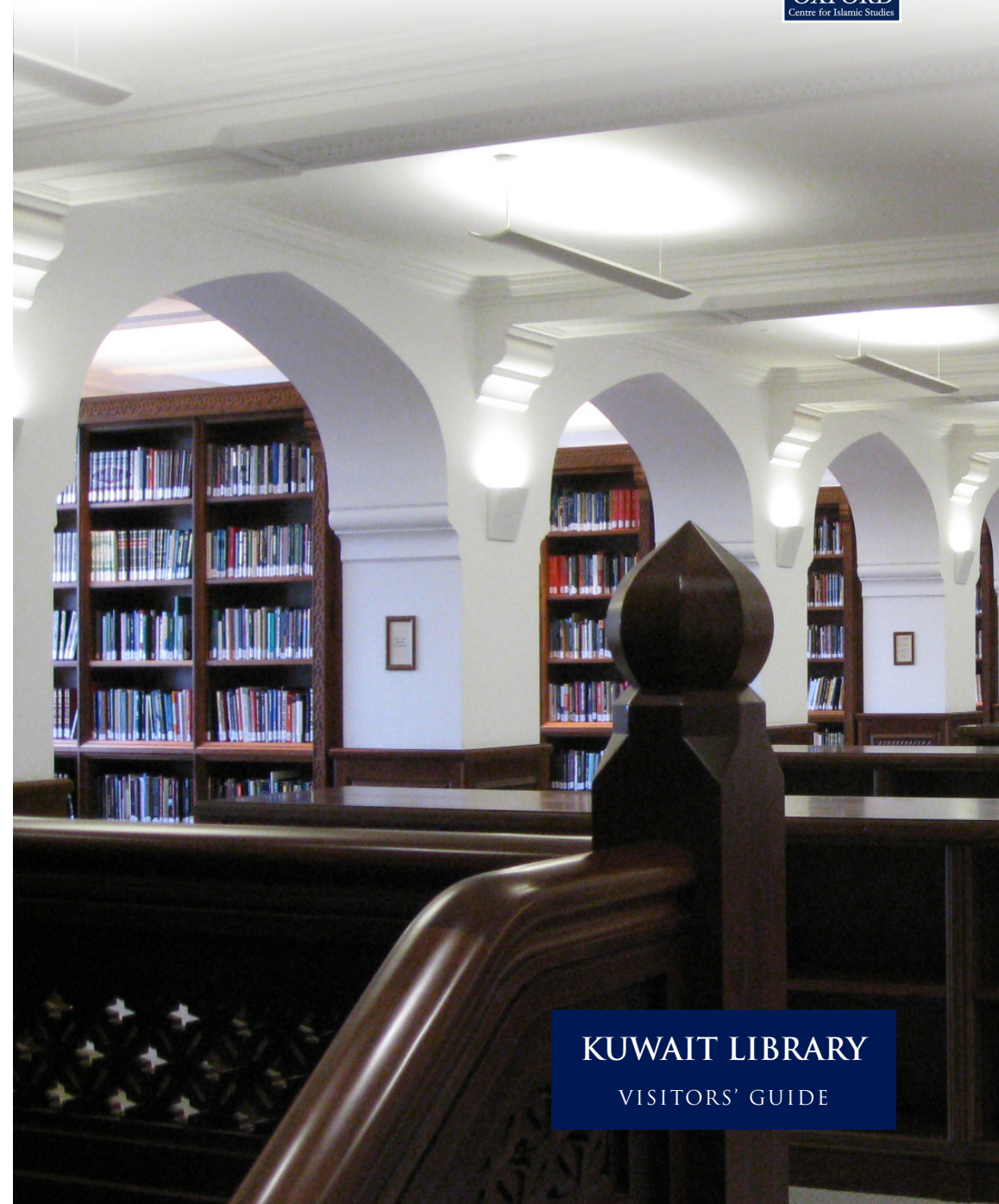

KUWAIT LIBRARY

VISITORS' GUIDE

## ABOUT US

The Kuwait Library holds, currently, a collection of over 17000 volumes in several languages. It provides researchers and students with a comprehensive range of material on Islam and the Muslim world. The Library's collection is reference-only. It is fully searchable on SOLO (location code 'ISL').

There are excellent photocopying, scanning, and printing facilities available on site. The Centre also provides an eduroam wireless connection as well as in-house guest Wi-Fi.

## ENTRANCE

Readers should enter via the Porter's Lodge on Marston Road.

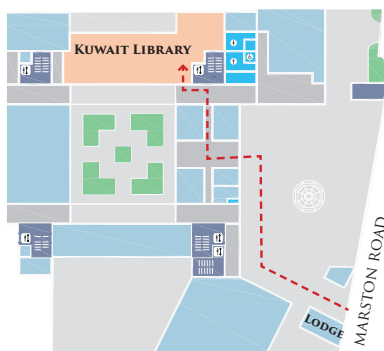

## READER CARDS

The Library may be used by members of the University of Oxford and others, by applying for a reader card.

Readers are requested to email a completed application to the Librarian ([librarian@oxcis.ac.uk](mailto:librarian@oxcis.ac.uk)) and attach a digital, passport-size photograph. University students should provide details of their course and college. Non-University applicants should supply a letter of recommendation from their relevant institution.

## LAYOUT OF THE LIBRARY

### Lower Ground Floor

The Lower Ground Floor has 32 secure lockers for the storage of personal belongings. (Bags, coats and umbrellas are not permitted in the Library.)

There is also a comfortable Common Room where readers can enjoy tea and coffee provided by the Centre.

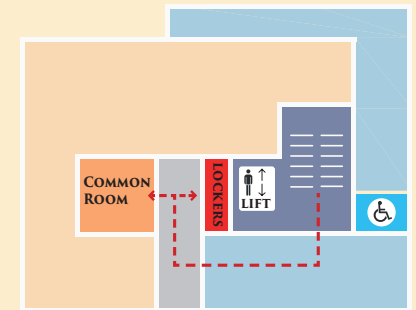

### Ground Floor

The collection is housed over the Upper and Lower Reading Rooms, accessible from the ground floor of the Centre.

Some areas of the library may only be accessed under supervision of the Library Staff.

